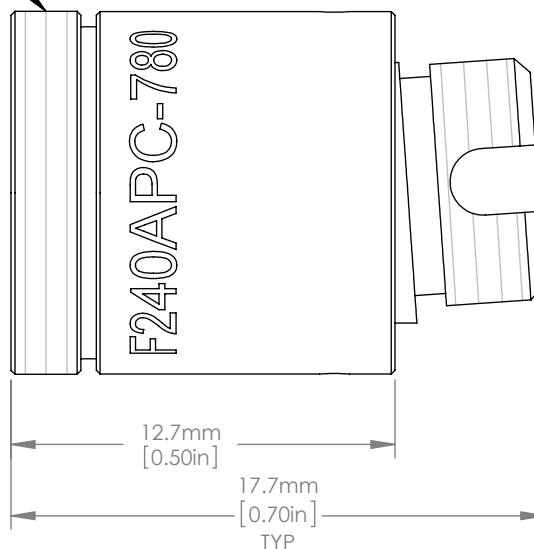



TABLE OF SPECIFICATIONS

THEORETICAL $1/e^2$ OUTPUT BEAM DIAMETER	1.5mm
THEORETICAL FULL ANGLE BEAM DIVERGENCE	0.036°
AR COATING	Ravg<0.5% FROM 650-1050nm
FIBER USED FOR ALIGNMENT	780HP
WAVELENGTH USED FOR ALIGNMENT	780nm

12mm THREAD-0.5 PITCH



∅12.0mm [0.47in]

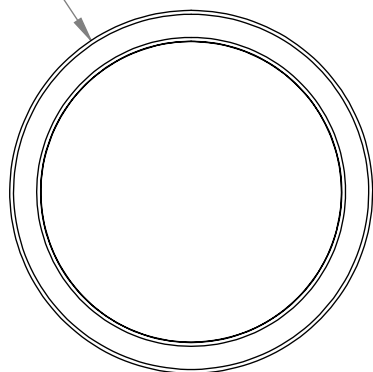

AR COATED ASPHERIC LENS
f=8.00mm, NA=0.50

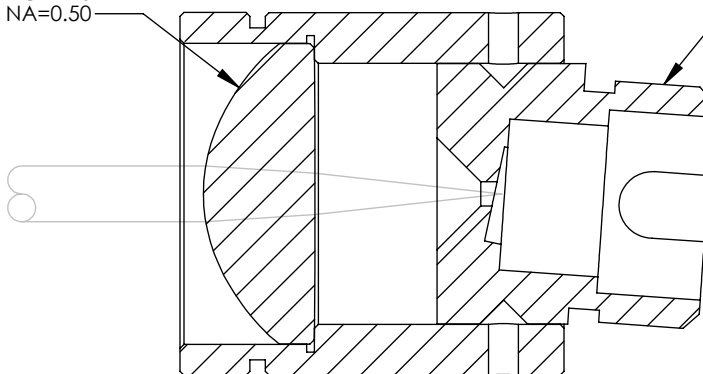

FC/APC CONNECTOR

Kokyo

株式会社光響
Email : info@symphotony.com
Web : https://www.symphotony.com/

THORLABS FIBER COLLIMATION PACKAGES ARE DESIGNED TO COLLIMATE A LASER BEAM PROPAGATING OUT THE END OF AN OPTICAL FIBER. EACH COLLIMATION PACKAGE IS FACTORY ALIGNED SO THAT THE LENS IS ONE FOCAL LENGTH AWAY FROM THE OUTPUT END OF THE FIBER.

FOR INFORMATION ONLY
NOT FOR MANUFACTURING PURPOSES

DRAWING PROJECTION			THORLABS www.thorlabs.com	
NAME	DATE	λ=780nm FC/APC COLLIMATION PACKAGE, NA=0.50, f=8.00mm		
DRAWN SFG	02/14/2011	MATERIAL	N/A	REV B
APPROVAL BW	05/21/2014	ITEM # F240APC-780		
COPYRIGHT © 2011 BY THORLABS		APPROX WEIGHT 7.5 g		
VALUES IN PARENTHESIS ARE CALCULATED AND MAY CONTAIN ROUND OFF ERRORS				