

Manual Variable Optical Attenuator (MVOA)

<b style="color: #008080;">Features High precision Wide attenuation range Low Insertion Loss	
<b style="color: #008080;">Application Optical communication systems test Optics lab use	

Specifications:

Parameter \ Type	Single Mode								Multi mode
Wavelength (nm)	1310	1550	1310 /1550	1064	980	850	780	630	850 or 1310
Bandwidth(nm)	± 40	± 40	± 40	± 20	± 20	± 20	± 20	± 20	± 40
Attenuation range (dB)	0.6 ~ 40	0.6 ~ 40	0.8 ~ 40	0.8~ 40	1.0-40	1.1-40	1.2-40	1.50-40	0.8 ~ 40
Insertion Loss (dB)	≤0.6	≤0.6	≤0.8	≤0.8	≤1.0	≤1.1	≤1.2	≤1.5	≤0.8
Return loss (dB)	≥50								
Fiber Type	SMF-28e		HI1060		HI780		HP630		62.5/125 or 50/125
Adjustment Precision (dB)	0.02								
PDL (dB)	≤0.15								
Operating temperature (°C)	0 ~ +70								
Storage temperature (°C)	-40 ~ +85								
Dimension (mm)	26 x 18 x 8								

Package Dimensions

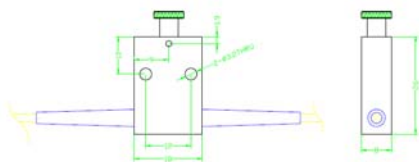

Ordering Information

MVOA	Wavelength	Adjustment Type	Pigtail Type	Fiber Type	Length	Connector
	1310=1310 1550=1550 1315=1310/1550 1064=1064 980=980nm 850=850nm 780=780nm 630=630nm	1= Hand adjustment	1=900um loose tube 2=2mm loose tube 3=3mm loose tube	1=SMF-28e 4=HI1060 7=HI780 8=HP630 2=50/125 3=62.5/125	0.8=0.8 1=1m	NE=None FA=FC/APC FC=FC/UPC SA=SC/APC SC=SC/UPC LC=LC/UPC LA=LC/APC XX=Other