

792nm~793nm 2W~2.5W Fiber Coupled Diode Laser Module

792nm|4-pin Package| 105um 200um 400um Fiber Core| High Power LD

WSLX-792-002-H

Wavespectrum Laser, Inc.

www.wavespectrum-laser.com

| PARAMETER | SYMBOL | VALUE | UNIT |
|--------------------------------------|-----------|-----------|------|
| Reverse Voltage | V_r | 2.0 | V |
| Operating Temperature | T_{op} | +15 ~ +35 | °C |
| Storage Temperature | T_{stg} | -40 ~ +60 | °C |
| Lead soldering temperature (10 sec.) | T_{is} | 260 | °C |

Features:

- 792nm
- 4-pin Package
- PD Optional

Applications:

- Medical laser treatment
- Pumping
- Others

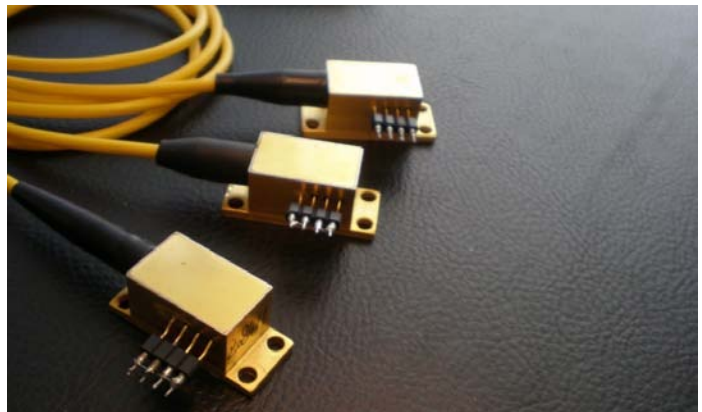

Specifications

WSLX-792-002-H

| | Min | Type | Max |
|---------------------------------------|------------------------------|---------|------|
| Center Wavelength@25°C | ---- | 792±5nm | ---- |
| Spectral Width (FWHM) | ---- | ---- | 2nm |
| Output Power | 2W | 2.2W | ---- |
| Temperature Coefficient of Wavelength | 0.28nm / °C | | |
| Threshold Current (Typ.) | 700mA | | |
| Operating Current (Typ.) | 3.4A | | |
| Operating Voltage | 2V | | |
| Recommended Case Temperature | 25°C | | |
| TEC Max. Current | ---- | | |
| TEC Max. Voltage | ---- | | |
| Fiber Core Diameter | 105um (200um 400um Optional) | | |
| Fiber Numerical Aperture | 0.22 | | |
| Fiber Length | 100cm | | |
| Connector Type | SMA905/ST/FC | | |
| Package Style | 4-pin | | |

Wavespectrum Laser, Inc.
www.wavespectrum-laser.com
wavespectrumlaser@gmail.com



4-pin Package View

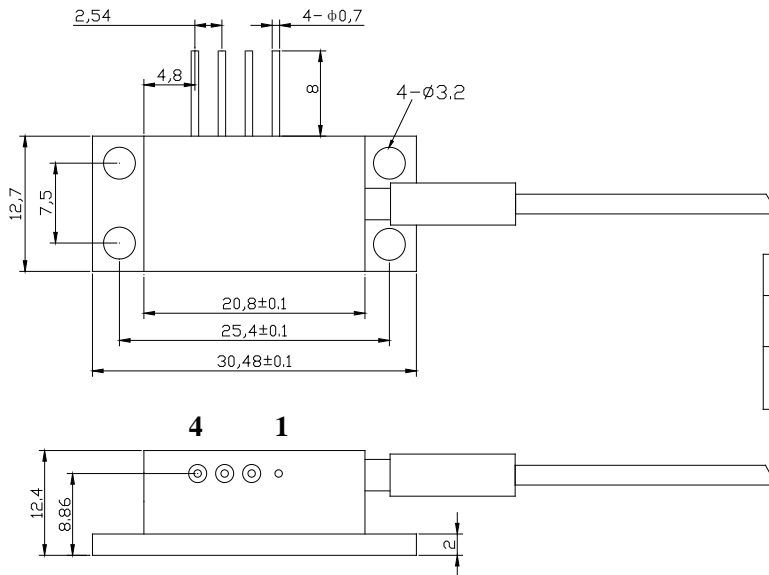

| PIN | FUNCTION |
|-----|----------|
| 1 | LD (+) |
| 2 | LD (-) |

Wavespectrum offer **Customized 792nm Fiber Coupled LD.**

- Customized Output Power
- Customized Fiber Core
- Dual-Wavelength or Tri-Wavelength Module Optional (such as 6w@792nm+350mw@635nm)

Contact us with info@wavespectrum-laser.com

Electrically shorten LD module and store in non-extreme conditions.
Suggest using the constant current power supply.

