

1550nm 1mw FP Coaxial Pigtailed Laser Diode with 9um SM Fiber

1550nm 1mw Fiber Coupled LD

WSLP-1550-001m-9-FP

Wavespectrum laser inc.

www.wavespectrum-laser.com

PARAMETER	SYMBOL	VALUE	UNIT
LD Reverse Voltage	V_r	2.0	V
PD Operating Current	$I_{f(PD)}$	2.0	mA
PD Reverse Voltage	$V_{r(PD)}$	15	V
Operating Temperature	T_{op}	-10 ~ +85	°C
Storage Temperature	T_{stg}	-40 ~ +85	°C
Lead soldering temperature (10 sec.)	T_{is}	260	°C
Features: <ul style="list-style-type: none"> ● 1550nm ● FP Laser Diode ● Built-in Monitor ● 9um Fiber Core ● Isolation Optional ● 1.25Gb/s , 2.5Gb/s Optional ● Coaxial/Receptacle package 			
Applications: <ul style="list-style-type: none"> ● Test Equipments ● Optical Bidi Module and Optical Receiver ● Optical Transmitter of Analog Signal ● Optical Transmitter of Data Signal 			
Specifications		WSLP-1550-001m-9-FP	
		Min	Type
Center Wavelength@25°C		1530nm	1550nm
Laser Type		FP	
Output Power		----	1mw
Fiber Core		9um	
Threshold Current (Typ.) I_{th}		5mA	15mA
Operating Current		----	20mA
Forward Voltage		----	1.1V
Monitor Current		0.1mA	----
PD Capacitance		----	10pF
PD Dark Current		----	0.1uA
Side Mode Suppression Ration		30dB	35dB
Package Style		Pigtail	Receptacle
Data Rate		1.25Gb/s	2.5Gb/s
Isolation		with	without
Connector Pin		TypeA	TypeB
Fiber Connector		FC/SC/ST/LC/MU	



Coaxial Package View

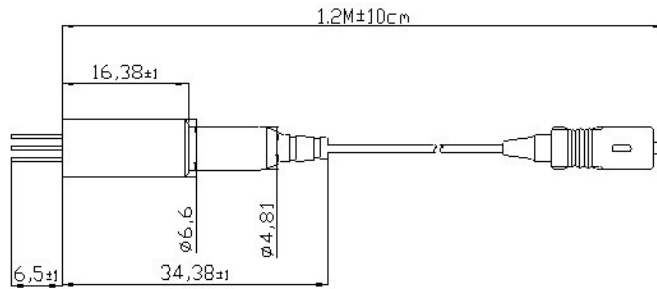

Bottom View

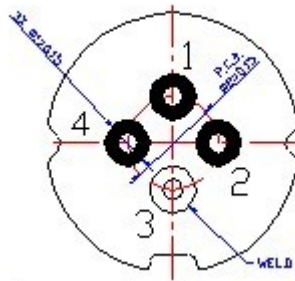

TYPE A
PIN ASSIGNMENT:

1	PD Cathode
2	PD Anode
3	LD Anode, GND
4	LD Cathode

Electrically shorten LD module and store in non-extreme conditions.
Suggest using the constant current power supply.



Please contact us:

Website: www.wavespectrum-laser.com(for more detailed information)

Email:info@wavespectrum-laser.com (for inquiry about this product)

