

Kokyo

株式会社 光響

Email : info@symphotony.com

Web : <https://www.symphotony.com/>



CATALOG

Multi-mode Laser Diode

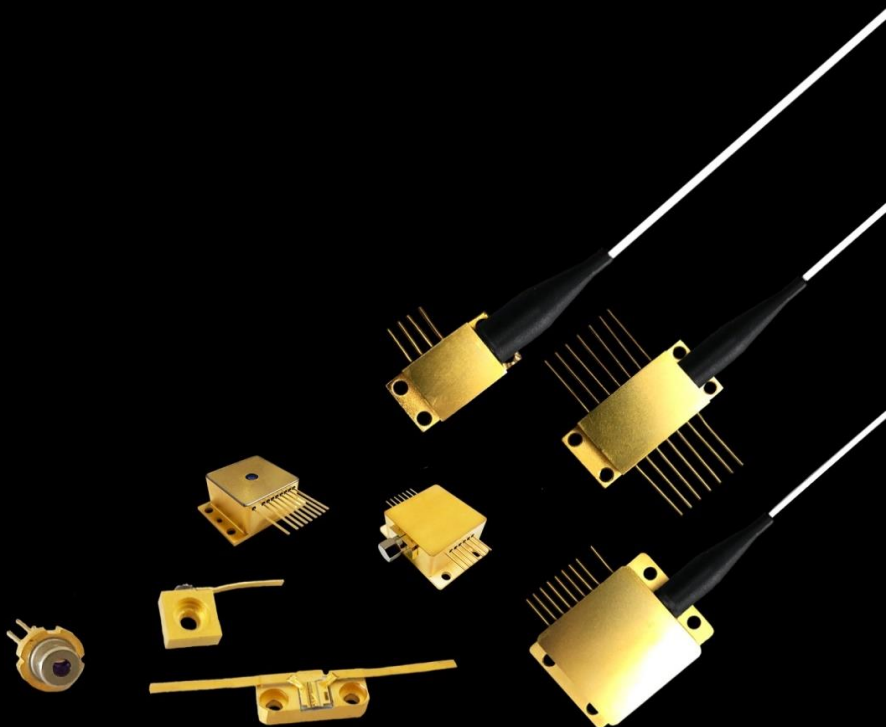

Product Portfolio

630nm 633nm
635nm 638nm
640nm 650nm
653nm 660nm
670nm 680nm
685nm 690nm

Red Laser

705nm
730nm 755nm 760nm
770nm 780nm 785nm
790nm 808nm 820nm
830nm 850nm 860nm
880nm 905nm 915nm
940nm 960nm 980nm
1064nm

IR Laser

505nm 510nm
520nm 525nm
532nm

Green Laser



Laser Diode

Fiber Coupled Laser Module

Fiber Detachable Laser Module

Laser System

425nm
435nm 445nm
450nm 455nm
460nm 465nm
473nm 480nm
488nm 495nm

Blue Laser

375nm
395nm 400nm
405nm 410nm
413nm

UV Laser

1270nm
1290nm 1310nm
1330nm 1350nm 1370nm
1390nm 1410nm 1430nm
1450nm 1470nm 1490nm
1510nm 1530nm 1550nm
1570nm 1590nm 1610nm
1625nm 1650nm
1920nm

IR Laser



WAVESPECTRUM GROUP was founded in 1999. It is comprised by a group of experienced and innovative experts in the fields of laser physics, materials science, electronic technology and mechanical design. It has established solid cooperation with some famous universities, research institutes and laboratories.

Wavespectrum products are widely used in space science, optical communication technology, laser display, laser medical, life sciences and materials processing. With the rapid development, R&D centers and production bases have been established in China and Europe. The current plant area is 4,000 square meters, including 2,000 square meters of Class 1,000 clean workshops.

Wavespectrum products include laser diodes, fiber-coupled laser modules and fiber-coupled laser systems with wavelengths from 375nm to 1920nm. Our products are used in medical, printing, laser display, life science, laser communication and other fields. At present, the products have all passed the certifications of ROHS, REACH, CE, etc. At the same time, we have got ISO9001 quality management system certification.

Wavespectrum has world-class R&D team, and it has the world first-class production processing plants. Our products can meet the military-grade production and design standards. The products are well acclaimed world-wide, such in Germany, Austria, the United States, Japan, South Korea and other parts of the world. We have established close cooperation with a number of well-known enterprises world-wide.

Wavespectrum offers laser products with wavelength ranges from 375nm to 1920nm.

375nm	395nm	400nm	405nm	410nm	413nm	435nm	445nm	450nm	455nm	460nm	465nm	473nm
480nm	488nm	495nm	505nm	510nm	520nm	525nm	532nm	630nm	633nm	635nm	638nm	640nm
650nm	653nm	660nm	670nm	680nm	685nm	690nm	705nm	730nm	755nm	760nm	770nm	780nm
785nm	790nm	808nm	820nm	830nm	850nm	860nm	880nm	905nm	915nm	940nm	960nm	980nm
1064nm	1210nm	1270nm	1280nm	1290nm	1310nm	1330nm	1350nm	1370nm	1390nm	1410nm	1430nm	1450nm
1470nm	1490nm	1510nm	1530nm	1550nm	1570nm	1590nm	1610nm	1625nm	1650nm	1720nm	1900nm	1920nm

Pls visit our website for more detailed information: <http://en.wavespectrum-laser.com.cn>

CONTACT US

Wavespectrum Laser Group Limited

Address : 2-2-1504, 2# Haitai Innovation 6th Road, Xiqing Dist, 300392, TianJin, China

Web : www.wavespectrum-laser.com.cn

Email : sales@wavespectrum-laser.com.cn

Tel : +86-022-87931118

Fax : +86-022-86392109

Distributors Wanted World-Wide!

Product Catalogue

Single Mode Laser Diode



Multi-mode Laser Diode



Single Mode Fiber Coupled Laser Module



Multi-mode Fiber Coupled Laser Module



Single Mode Fiber Detachable Laser Module



Multi-mode Fiber Detachable Laser Module



405nm Fiber Detachable Laser Module



405nm High Power Fiber Coupled Laser Source



Medical Laser Module

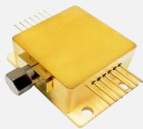

Window Package High Power Laser Diode



Triplex (RGB) Fiber Coupled White Light Laser Module



Triplex (RGB) Fiber Coupled White Light Laser Source



Duplex (Dual- λ) Single Mode Fiber Coupled Laser Module



Red & Green Aiming Beam for Fiber Laser



Product Catalogue

**Turnkey Fiber Coupled
Diode Laser System**



**OEM Fiber Coupled
Diode Laser System**



**3-channel (Multi-channel)
Fiber Coupled Laser System**



**3-wavelength (Multi-λ)
Fiber Coupled Laser System**



**High Power Fiber
Bundled Laser Module**



**Multi-wavelength Fiber
Coupled Laser Module**



Collimated Laser Diode



Photodiode



Multi-mode Laser Diode

PRODUCT FEATURE

375nm~1920nm
 Multi-mode Beam Output
 150mW~15W Output Power
 TO18 /TO5 /TO3 /C-mount/E-mount Package
 FAC Lens Optional
 Built-in Photodiode Optional
 Long Lifetime
 High Stability



PRODUCT OVERVIEW

Multi-mode Laser Diode is the competitive product of WAVESPECTRUM.

We offer the high quality laser diode with multi-mode beam, the wavelength range is from 375nm to 1920nm and the output power is from 150mW to 15W. The photodiode is optional for the lasers. Meanwhile, the FAC Lens is optional. With FAC Lens, we can offer 1:1 Square Beam and 1:4 , 1:8 Line Shape Beam. The standard package can be TO18, TO5, TO3, C-mount , E-mount or H-mount package.

WAVESPECTRUM adopt AuSn solder technology to package the laser diode. To ensure the long-term reliability, each laser diode will undergo rigorous testing and aging in factory. Meanwhile the high-low storage temperature circulation is also necessary for each laser diode. We set the storage temperature range from -40°C to +85°C, and it lasts 10 cycles, which will ensure the long-term Stability of Laser Diode.



Wavelength	Part Number	Output Power	Mode Type	Laser Type	Package	PD	FAC
375nm	WSLD-375-150m-1	150mW	MM	FP	TO18	×	×
395nm	WSLD-395-300m-1	300mW	MM	FP	TO18	×	×
405nm	WSLD-405-300m-1	300mW	MM	FP	TO18	×	×
	WSLD-405-500m-1	500mW	MM	FP	TO18	×	×
	WSLD-405-800m-1	800mW	MM	FP	TO18	×	×
445nm	WSLD-445-1500m-1	1.5W	MM	FP	TO18	×	×
	WSLD-445-003-2	3W	MM	FP	TO5	×	×
	WSLD-445-005-K	5W	MM	FP	TO5	×	×
	WSLD-445-005-2	5W	MM	FP	TO5	×	×
	WSLD-445-005-2-FAC	5W	MM	FP	TO5	×	√
465nm	WSLD-465-003-K	3W	MM	FP	TO5	×	×
	WSLD-465-003-2	3W	MM	FP	TO5	×	×
	WSLD-465-003-2-FAC	3W	MM	FP	TO5	×	√
520nm	WSLD-520-600m-2	600mW	MM	FP	TO5	×	×
	WSLD-520-1500m-2	1.5W	MM	FP	TO5	×	×
	WSLD-520-1500m-K	1.5W	MM	FP	TO5	×	×
	WSLD-520-1500m-2-FAC	1.5W	MM	FP	TO5	×	√
525nm	WSLD-525-1500m-2	1.5W	MM	FP	TO5	×	×
	WSLD-525-1500m-K	1.5W	MM	FP	TO5	×	×
	WSLD-525-1500m-2-FAC	1.5W	MM	FP	TO5	×	√
635nm	WSLD-635-500m-1-FAC	500mW	MM	FP	TO18	×	√
	WSLD-635-700m-1	700mW	MM	FP	TO18	×	×
	WSLD-635-001-2	1W	MM	FP	TO5	×	×
	WSLD-635-002-2	2W	MM	FP	TO5	×	×
	WSLD-635-001-2-FAC	1W	MM	FP	TO5	×	√
	WSLD-635-002-2-FAC	2W	MM	FP	TO5	×	√
660nm	WSLD-660-001-C	1W	MM	FP	C-mount	×	○
	WSLD-660-001-3	1W	MM	FP	TO3	×	○
	WSLD-660-001-E	1W	MM	FP	E-mount	×	○
	WSLD-660-1500m-C	1.5W	MM	FP	C-mount	×	○
	WSLD-660-1500m-3	1.5W	MM	FP	TO3	×	○
	WSLD-660-1500m-E	1.5W	MM	FP	E-mount	×	○
690nm	WSLD-690-001-C	1W	MM	FP	C-mount	×	○
	WSLD-690-001-3	1W	MM	FP	TO3	×	○
	WSLD-690-001-E	1W	MM	FP	E-mount	×	○
760nm	WSLD-760-002-E	2W	MM	FP	E-mount	×	○
	WSLD-760-002-H	2W	MM	FP	H-mount	×	○
	WSLD-760-005-E	5W	MM	FP	E-mount	×	○

Note: √:Yes, ○:Optional, ×:No.

Wavelength	Part Number	Output Power	Mode Type	Laser Type	Package	PD	FAC
760nm	WSLD-760-005-H	5W	MM	FP	H-mount	×	○
770nm	WSLD-770-004-C	4W	MM	FP	C-mount	×	○
	WSLD-770-004-H	4W	MM	FP	H-mount	×	○
785nm	WSLD-785-005-C	5W	MM	FP	C-mount	×	○
	WSLD-785-005-E	5W	MM	FP	E-mount	×	○
	WSLD-785-005-H	5W	MM	FP	H-mount	×	○
	WSLD-785-008-E	8W	MM	FP	E-mount	×	○
	WSLD-785-008-H	8W	MM	FP	H-mount	×	○
808nm	WSLD-808-300m-1-PD	300mW	MM	FP	TO18	√	×
	WSLD-808-500m-1-PD	500mW	MM	FP	TO18	√	×
	WSLD-808-001-2-PD	1W	MM	FP	TO5	√	○
	WSLD-808-002-2	2W	MM	FP	TO5	○	○
	WSLD-808-003-C	3W	MM	FP	C-mount	×	○
	WSLD-808-003-3	3W	MM	FP	TO3	×	○
	WSLD-808-005-C	5W	MM	FP	C-mount	×	○
	WSLD-808-005-3	5W	MM	FP	TO3	×	○
	WSLD-808-010-E	10W	MM	FP	E-mount	×	○
	WSLD-808-010-H	10W	MM	FP	H-mount	×	○
830nm	WSLD-830-001-2-PD	1W	MM	FP	TO5	√	○
	WSLD-830-003-C	3W	MM	FP	C-mount	×	○
	WSLD-830-003-3	3W	MM	FP	TO3	×	○
850nm	WSLD-850-300m-1-PD	300mW	MM	FP	TO18	√	×
	WSLD-850-500m-1	500mW	MM	FP	TO18	×	×
	WSLD-850-500m-1-PD	500mW	MM	FP	TO18	√	×
	WSLD-850-800m-1	800mW	MM	FP	TO18	×	×
	WSLD-850-001-1	1W	MM	FP	TO18	×	×
880nm	WSLD-880-003-C	3W	MM	FP	C-mount	×	○
	WSLD-880-003-3	3W	MM	FP	TO3	×	○
	WSLD-880-008-E	8W	MM	FP	E-mount	×	○
	WSLD-880-008-H	8W	MM	FP	H-mount	×	○
915nm	WSLD-915-012-E	12W	MM	FP	E-mount	×	○
	WSLD-915-012-H	12W	MM	FP	H-mount	×	○
	WSLD-915-015-E	15W	MM	FP	E-mount	×	○
	WSLD-915-020-E	20W	MM	FP	E-mount	×	○
940nm	WSLD-940-300m-1-PD	300mW	MM	FP	TO18	√	×
	WSLD-940-001-2-PD	1W	MM	FP	TO5	√	○
	WSLD-940-012-E	12W	MM	FP	E-mount	×	○
	WSLD-940-012-H	12W	MM	FP	H-mount	×	○

Note: √:Yes, ○:Optional, ×:No.

Wavelength	Part Number	Output Power	Mode Type	Laser Type	Package	PD	FAC
980nm	WSLD-980-200m-1-PD	200mW	MM	FP	TO18	√	×
	WSLD-980-500m-1-PD	500mW	MM	FP	TO18	√	×
	WSLD-980-001-2-PD	1W	MM	FP	TO5	√	○
	WSLD-980-003-C	3W	MM	FP	C-mount	×	○
	WSLD-980-003-3	3W	MM	FP	TO3	×	○
	WSLD-980-004-C	4W	MM	FP	C-mount	×	○
	WSLD-980-004-3	4W	MM	FP	TO3	×	○
	WSLD-980-012-E	12W	MM	FP	E-mount	×	○
	WSLD-980-012-H	12W	MM	FP	H-mount	×	○
	WSLD-980-015-E	15W	MM	FP	E-mount	×	○
	WSLD-980-020-E	20W	MM	FP	E-mount	×	○
1064nm	WSLD-1064-010-E	10W	MM	FP	E-mount	×	○
	WSLD-1064-010-H	10W	MM	FP	H-mount	×	○
1450nm	WSLD-1450-002-E	2W	MM	FP	E-mount	×	○
	WSLD-1450-002-H	2W	MM	FP	H-mount	×	○
1470nm	WSLD-1470-003-E	3W	MM	FP	E-mount	×	○
	WSLD-1470-003-H	3W	MM	FP	H-mount	×	○
1490nm	WSLD-1490-003-E	3W	MM	FP	E-mount	×	○
	WSLD-1490-003-H	3W	MM	FP	H-mount	×	○
1530nm	WSLD-1530-002-E	2W	MM	FP	E-mount	×	○
	WSLD-1530-002-H	2W	MM	FP	H-mount	×	○
1550nm	WSLD-1550-2500m-E	2.5W	MM	FP	E-mount	×	○
	WSLD-1550-2500m-H	2.5W	MM	FP	H-mount	×	○
1570nm	WSLD-1570-2500m-E	2.5W	MM	FP	E-mount	×	○
	WSLD-1570-2500m-H	2.5W	MM	FP	H-mount	×	○
1920nm	WSLD-1920-700m-E	700mW	MM	FP	E-mount	×	○
	WSLD-1920-700m-H	700mW	MM	FP	H-mount	×	○

Note: √:Yes, ○:Optional, ×:No.

Beam Spot Shape:

With FAC lens (1:1)

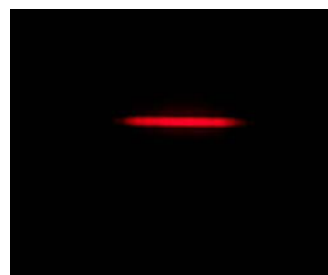

With FAC lens (1:4)

TO18 Package View :

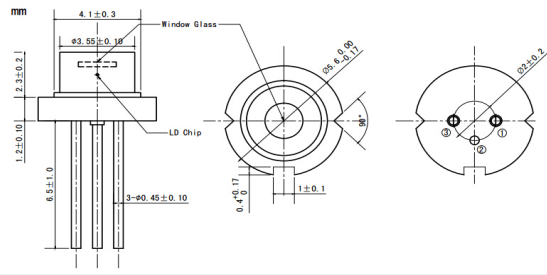

TO5 Package View :

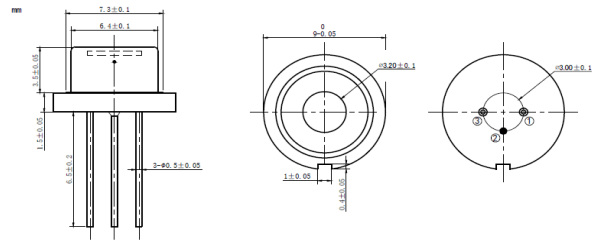

TO3 Package View :

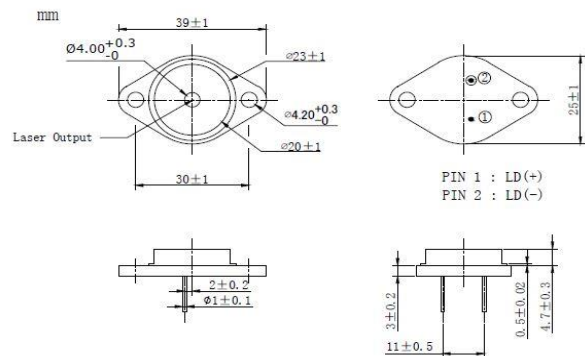

C-mount Package View :

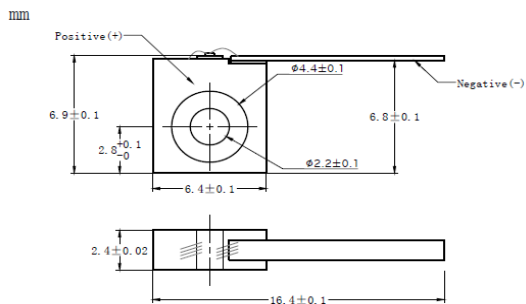
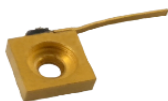

E-mount Package View :

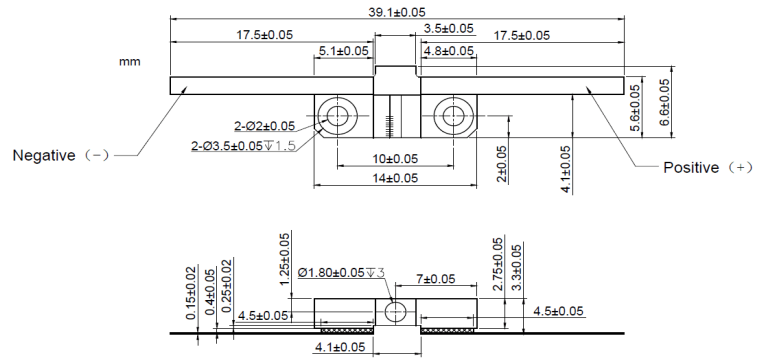

H-mount Window Package View:

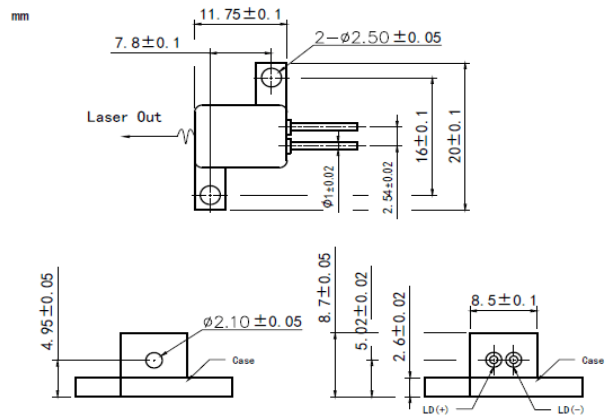
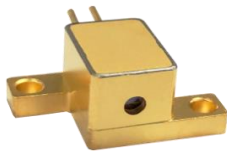

9-Pin HHL Window Package View (Built-in TE Cooler):

