

## 2W High Power 1064nm Isolator

<b>Features</b>	
High Power High Isolation High Reliability	
<b>Application</b>	
Fiber Laser	

### Specifications

Parameters	Unit	Non-PM fiber Isolator	PM fiber Isolator
Stage		Single Stage	Single Stage
Center Wavelength ( $\lambda_c$ )	nm	1064	
Typ. Isolation	dB	35	35
Isolation at 23°	dB	≥28	≥28
Typ. Insertion Loss	dB	1.7	1.7
Insertion Loss at 23° (300mW)	dB	≤2.0	≤2.0
Insertion Loss at 23° (1W)	dB	≤2.5	≤2.5
Insertion Loss at 23° (2W)	dB	≤3.0	≤3.0
Return Loss	dB	≥50 / 50	≥50 / 50
PDL	dB	≤0.2	--
Extinction Ratio ( B Type)	dB	--	≥18
Extinction Ratio (F Type)	dB	--	≥20
Optical Power (Average power)	W	2	
Peak Power for ns pulse	Kw	1	
Fiber Type		HI1060	PM 980 Panda Fiber
Operating Temperature	□	-5 to +50	
Storage Temperature	□	-40 to +85	
Package Dimension	mm	65x17x11.5	

### Package Dimensions

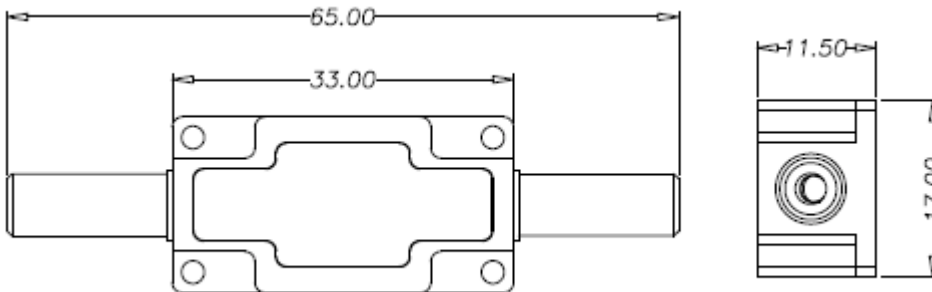

### Ordering Information

HPIS HPMIS	Wavelength	Working axis	Pigtail	Fiber	length	Package	Power
	1064	F=Fast axis Blocked B=Both axis working	250=250um bare fiber 900=900um loose tube	1=HI1060 5=PM980	0.8=0.8m S=Specify	65x17x11.5	2W