

➤ Single Mode Pump Laser Protector(SMPLP)

Features

- High Power Handling
- Low Insertion

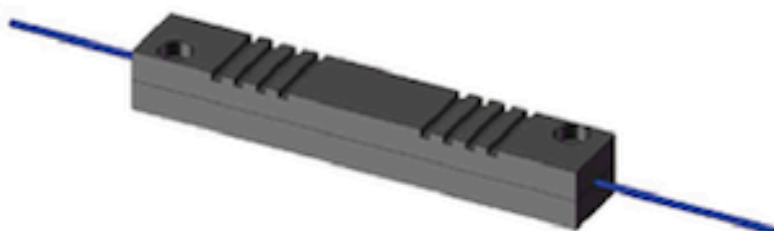

Applications

- Fiber Laser

Product Characteristics Performance

Parameters	Unit	Values
Pump Laser Central Wavelength	nm	915 or 975
Operating Wavelength Range	nm	± 15
Typ. Pump Insertion Loss	dB	0.3
Max. Pump Insertion Loss(-5~70℃)	dB	0.5
Operating Signal Wavelength Range	nm	1020~1120
Min. Backward Signal Attenuation	dB	50
Max. Optical Power (CW)	W	0.5 7 10
Min. Return Loss	dB	50
Fiber Type	/	Hi 1000 Fiber
Operation Temperature	℃	-5 ~ +65
Storage Temperature Range	℃	-40 ~ +85

Package Dimensions

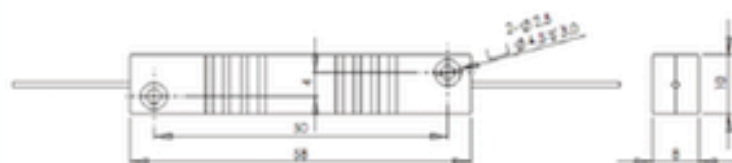

Ordering Information

SMPLP-①①①-②②-③③-
④④-⑤⑤

①①①: Wavelength
915-915nm
975-975nm

②②: Optical Power
Z5-500mW
10-10W

③③: Connector Type on In&Out
N-None
S-Specify

④④: Fiber Jacket on In&Out
B-250um Bare Fiber
L-900um Loose Tube

⑤⑤: Fiber Length
10-1.0m
SS-Specify

Kokyo
株式会社光響

住所：京都市下京区烏丸通四条下ル水銀屋町637番地 第5長谷ビル2階

Email : info@symphotony.com

TEL : 070 - 6582 - 2430

Web : <http://www.symphotony.com/>

FAX : 075 - 320 - 1604